

Courses up the
 river from
 Post to Walnut
 S 45 W 20
 S 72 W 52
 N 35 W 16
 N 10 E 19 1/2
 S 79 W 42
 S 27 W 10
 S 54 W 30
 N 80 W 18
 to Walnut
 Corner of Ed
 Johnston

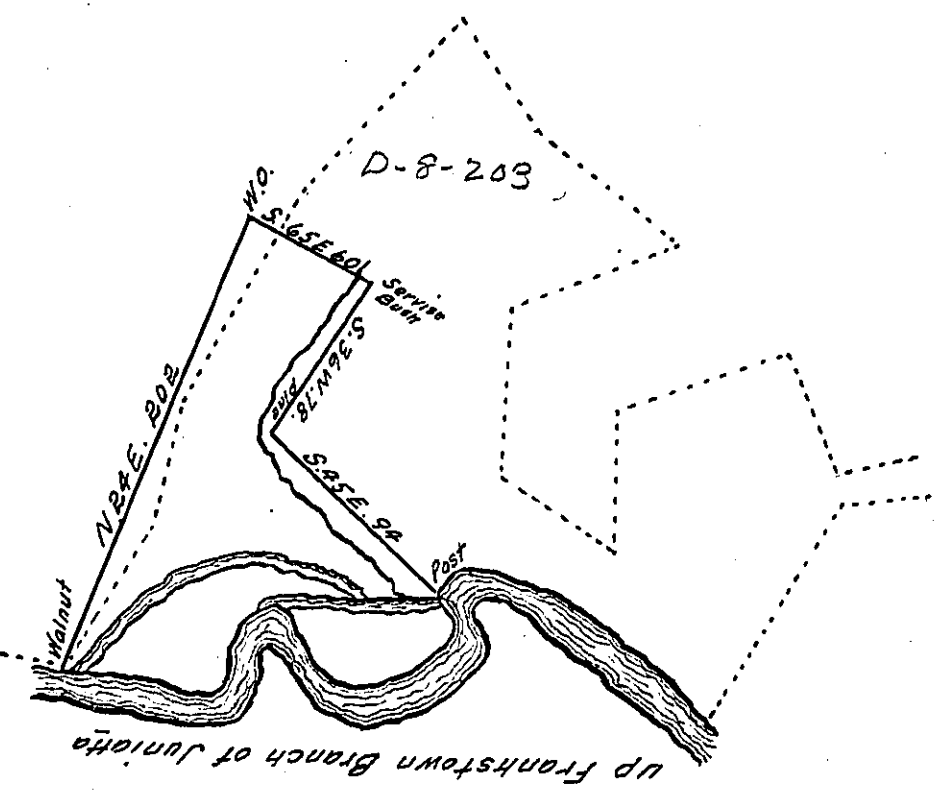

Situate on the North Side of the Frankstown Branch of Juniata;
 about one half mile below Frankstown, in Frankstown township Huntingdon
 County - containing Seventy Eight Acres and nine perches and allowance
 of six per Cent - Surveyed the 22nd day of November 1784 for John Thompson
 on Warrant dated the 17th day of January 1775 -

To Jacob Spangler Esq Daniel Africa D.S.
 Surveyor General

The dotted lines and River represents part of the draught of a tract of land
 surveyed for Leonard Wolf on Warrant dated the 15th day of November
 1785 - this tract interferes Sixty Eight acres with the John Thompson tract
 Leonard Wolf conveyed to Jacob Miller who conveyed to Mr Lingenfelter
 John & Phillip Hetrick & Mr Garmer Mr Garmer devised to Jacob Garmer
 the present owner -
 John & Phillip Hetrick conveyed to Christian Ghost the present owner -
 they also conveyed part of said tract to Samuel Thomas who conveyed
 to Mr Larkins who conveyed to David French who conveyed to Michael
 Hileman the present owner -
 Leonard Wolf, pat^r

IN TESTIMONY that the above is a copy of the original remaining on file in
 the Department of Internal Affairs of Pennsylvania, made
 conformably to an Act of Assembly approved the 16th day of
 February, 1833, I have hereunto set my Hand and caused
 the Seal of said Department to be affixed at Harrisburg,
 this Eleventh day of December 1908

Henry Howell
 Secretary of Internal Affairs.